

GROUND FLOOR PLAN

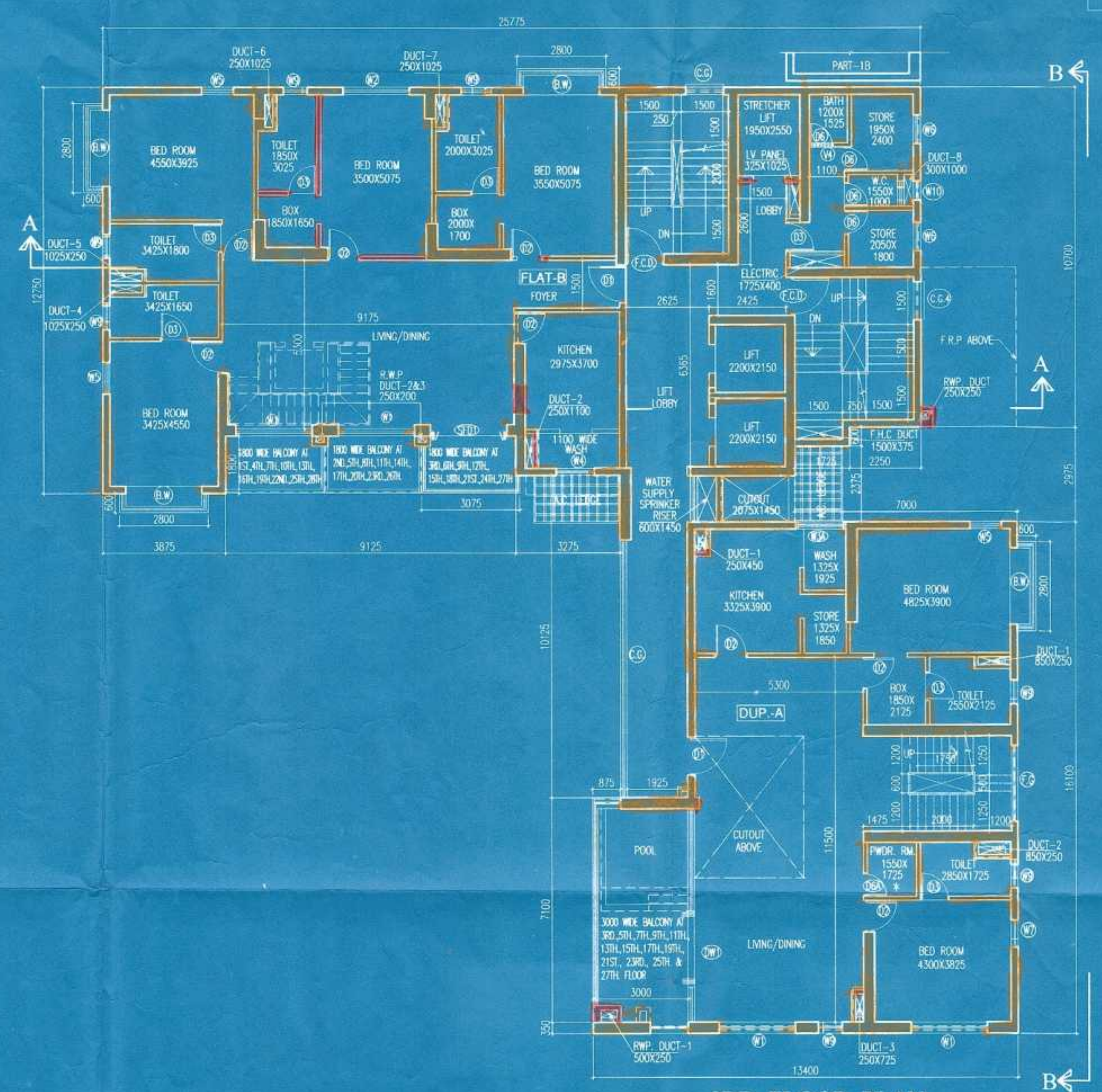

3RD. FLOOR PLAN

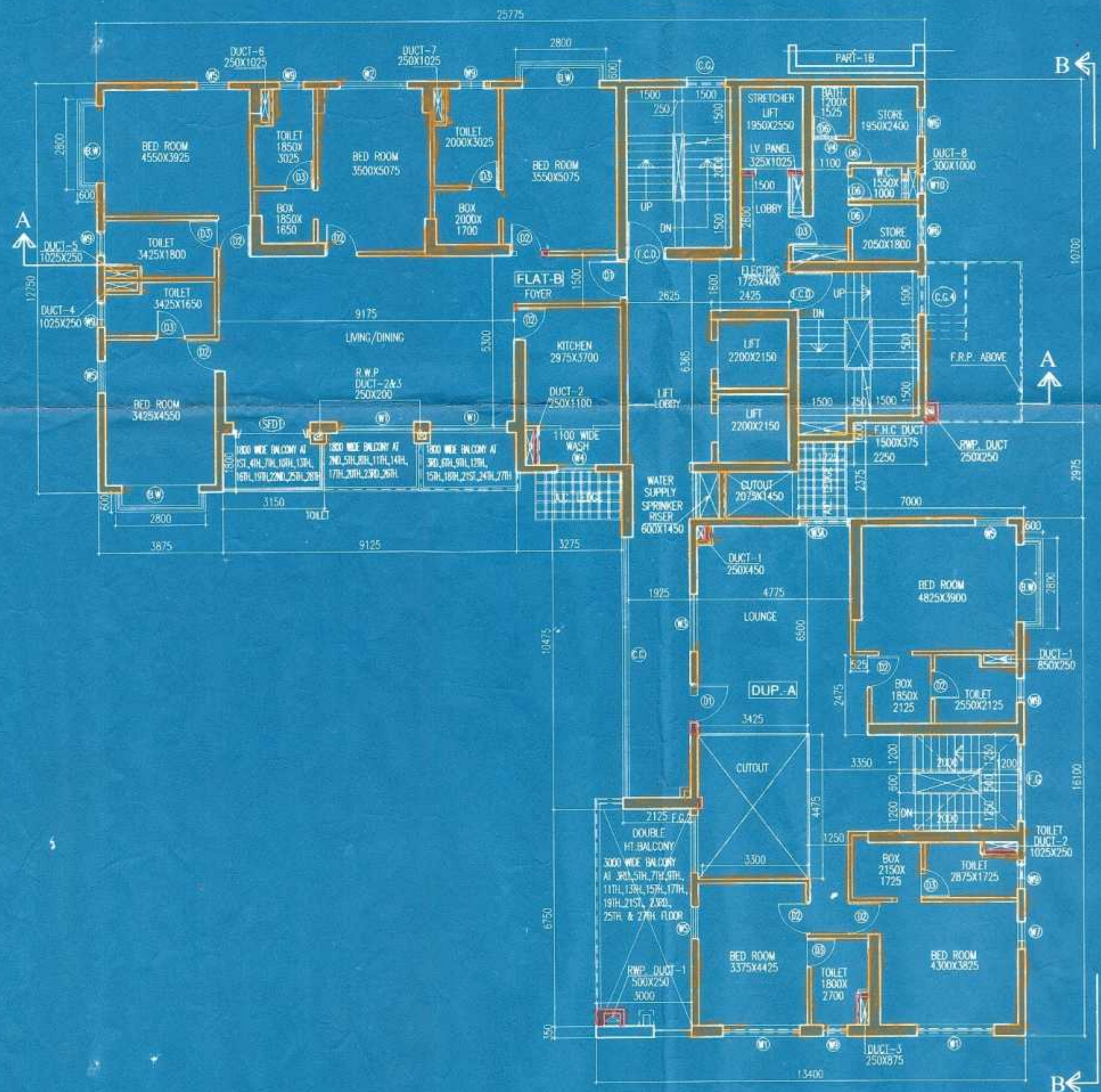

4TH. FLOOR PLAN

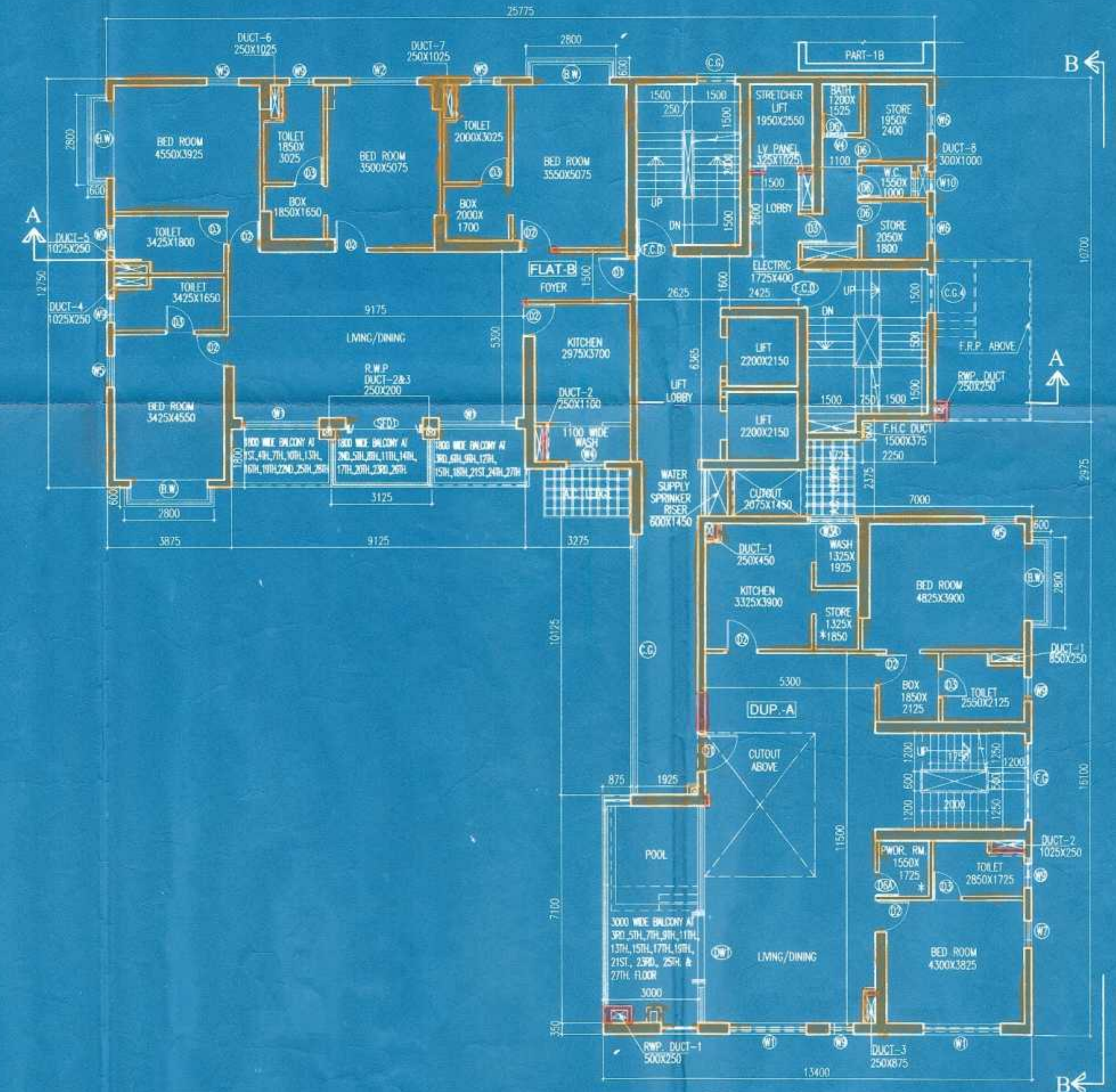

5TH. FLOOR PLAN

NO	SILL	LINTEL	SIZE
SD1		2450	750X2450
W1	150	2180	2400X2300
W2	150	2450	2100X 2300
W3	150	2150	1000X 2150
W4	150	2450	1800X 2300
W5	150	2450	1500X 2300
W6	150	2450	1200X 2300
W7	150	2450	1200X 2020
W8	150	2450	850X 1100
W9	150	2450	750X2300
W10	1350/1688	2450/2768	2450X1100
W11	1250	2150	600X900
SW1	150	2450	1000X2300
SW2	150	2450	1000X2300
SW3	150	2170	1200X2020
SW4	830	2170	1200X2070
DW	150	2450	2800X2300
D		2450	1800X2450
Da		2450	2000X2450
D1		2450	1200X2450
D2		2450	1500X2450
D2a	250	2300	900X2450
D3		2450	900X2450
D4		2150	1200 X 2150
D5		2150	900 X 2150
D6		2150	750 X 2150
D6a		2450	750 X 2450
D7		2150	600 X 2150
D8	250	2450	850 X 2750
F.C.D. 1		2150	1000 X 2150
F.C.D. 2		2150	1200 X 2150
DW1		2150	6750 X 2450
DW2		2750	3450 X 2750
DW3		2750	2400 X 2750
DW4		2450	2400 X 2450
DW5		2450	2100 X 2450
SFD		2450	3825 X 2450
SFD1		2450	2400 X 2450
SFD2		2450	2100 X 2450
SFD3		2450	1800 X 2450
V	1900	2300	2400X2450
V1	1900	2300	1800X2550
V2	1900	2300	1200X2550
V3	1900	2300	900X2550
V4	1900	2300	750X2550
F.G. 1	150	2450	2400X2300
F.G. 2	150	2450	2100X2300
F.G. 3	150	2450	1800X2300

TWOJI PARK APARTMENTS (P) LTD.  
*[Signature]*  
 Director

SIGNATURE OF OWNER

CERTIFICATE OF STRUCTURAL ENGINEER

THIS IS TO CERTIFY THAT THE STRUCTURAL DESIGN AND DRAWING OF BOTH FOUNDATION AND SUPER STRUCTURE OF THE BUILDING HAS BEEN MADE BY ME CONSIDERING ALL POSSIBLE LOADS INCLUDING THE SEISMIC LOAD AS PER THE NATIONAL BUILDING CODE OF INDIA AND CERTIFIED THAT IT IS SAFE AND STABLE IN ALL RESPECTS.

*Utpal Sanyal*

Utpal Sanyal  
 U.P. Sanyal & Co. (P) Ltd.  
 10, Park Road, Kolkata - 700 002

SIGNATURE OF STRUCTURAL ENGG.  
 M. K. ROY  
 B.C. (1980), M.Sc. (1982), M.Tech. (1984), Ph.D. (1988)  
 A.M.S.E. (I), S.M.S.E. (I), S.T.R.A.C.E. (I) (India)  
 Membership No. 20100000  
 JMC, Enam Road, Kolkata - 700 002

SIGNATURE OF STRUCTURAL REVIEWER

CERTIFICATE OF GEOTECHNICAL ENGINEER

IT IS CERTIFIED THAT THE COMPREHENSIVE GEO-TECHNICAL REPORT ON SOIL INVESTIGATION HAS BEEN PREPARED BY ME FOR DESIGN AND CALCULATION OF THE FOUNDATION BY ANALYZING THE SOIL SAMPLE FOR ESTIMATING THE BEARING CAPACITY OF THE SOIL ON WHICH FOUNDATION IS EXTENDED UP TO APPROPRIATE DEPTH THAT HAS BEEN PROPOSED IN THE GEO-TECHNICAL REPORT.

Dr. C. E. Testing Company Pvt. Ltd.  
 Geotechnical Consultant

Dr. M. K. Roy (M.Tech., Ph.D.)  
 B.E. (Civil), Ph.D. (Geotech)

SIGNATURE OF GEO-TECHNICAL ENGG.

CERTIFICATE OF ARCHITECT

I DO HEREBY CERTIFY WITH FULL RESPONSIBILITY THAT THE BUILDING PLAN HAS BEEN DRAWN UP AS PER K.M.C. BUILDING RULE - 2009 AS AMENDED FROM TIME TO TIME THAT THE WIDTH OF THE ABUTTING ROAD CONFORM WITH THE PLAN AND IT IS A BUILDABLE SITE NOT A TANK OR A FILLED UP TANK. THE SITE PLAN, LOCATION PLAN AGREES WITH THE SITE. THE PLOT IS DEMARCATED BY BOUNDARY WALLS & MEASUREMENTS TALLY WITH THE REGD. DEED PLAN.

JAY PRAKASH BHARAT KUMAR AGRAWAL  
 S. Archt. (I.A.)  
 Reg. No. GA/65/10093  
 ARCHITECT (S. No. 2291)

SIGNATURE OF ARCHITECT

TITLE  
 GROUND FLOOR, THIRD FLOOR, FOURTH FLOOR AND FIFTH FLOOR PLAN

PROJECT  
 PLAN SHOWING CHANGES U/R-26 (2a)&(2b) OF K.M.C. BLDG. RULE 2009 FROM THE SANCTIONED PLAN WIDE B.P. NO. - 201580192 DATED - 31.03.16 FOR PARTLY (G+XX) & PARTLY (G+XXII) & PARTLY (G+XXIII) STORED RESIDENTIAL BUILDING AT PREMISES NO. 225B, A.J.C. ROSE ROAD, KOLKATA - 700 020.  
 WARD NO. - 69 BOBROUGH - VIII & FURTHER RECALLARISED U/R-26 (2a)&(2b) & U/R 69A(1)(a) OF K.M.C. BLDG. RULE 2009 APPROVED BY M.B.C. DATED - 10.01.17

ARCHITECTS

AGRAWAL & AGRAWAL

BARODA KOLKATA

SCALE - 1:100 DATE DEALT CHECKED

SHEET NO. - 6 15.02.18 SAYANTANI SUBHASHISH

U/R-26(2a) & (2b) of  
K.M.C. Building rules  
2009 approved by  
D. G. (Retiree).....  
Dr. S. C. Saha.....

KOLKATA MUNICIPAL CORPORATION  
BUILDING DEPTT.  
PLANS APPROVED U/R 26(2a) & (2b) of  
K.M.C. BUILDING RULES 2009  
B.P. No. 2015/3012 D.D. 10.8.2015  
BR. NO. 241  
Subscribed by \_\_\_\_\_  
Assistant Engineer Br. No. VIII Ex. Engineer Br. No. VII

This Plan is to be Treated As Part  
And Parcel And Contiguous To  
B. S. Plan No. 2015/3012  
Dated 10.8.2015  
Ex. Engineer (B) \_\_\_\_\_  
Br. No. :- VII

